

SMC Series

SMC 系列产品是按照 MIL-C-39012、IEC169-9 和 CECC22140 详细规范研制生产的一种小型螺纹连接式射频同轴连接器，具有体积小、质量轻、抗震性好、可靠性高等特点，供无线电设备和仪器中连接射频同轴电缆用。

The SMC series are screw coupling miniature coaxial connectors which are produced according to the specifications of MIL-C-39012, IEC169-9 and CECC22140. They have the characteristics of light weight, small size and vibration-proof, are especially suitable for connection with RF coaxial cables in electronic equipment and instrument.



金润信电子科技有限公司

主要技术特性 Technical Characteristics:

环境温度范围 Temperature range	-65~+165℃	
电气性能 Electrical Characteristics		
特征阻抗 Characteristic impedance	50Ω; 75Ω	
工作电压 Working voltage	250V max(有效值)	
频率范围 Frequency range	0~10GHz	
介质耐压 Dielectric withstanding voltage	海平面 at sea level: 750V(volts RMS)	
接触电阻 Contact resistance	内导体 center contact	≤6.0mΩ
	外导体 Outer contact	≤1.0mΩ
绝缘电阻 Insulation resistance	≥1000MΩ	
电压驻波比 VSWR	直式 straight	≤1.25
	弯式 right - angle	≤1.35
材料与涂覆 Mechanical Characteristics		
壳体和其它金属零件 Body or other metallic parts	黄铜镀金 Brass, gold plated	
插针 Male center contacts:	黄铜镀金 Brass, gold plated	
插孔 Female center contacts:	铍青铜镀金 Beryllium copper, gold plated	
绝缘体 Insulators:	聚四氟乙烯 PTFE	
压接套 Crimp ferrules:	铜合金镀镍或镀金 Copper alloy, nickel or gold plated	
密封件 Sealing washer	硅橡胶 Silicone rubber	
连接器机械耐久性 Connector durability	500 次 Cycles	

界面尺寸 Interface Mating Dimensions

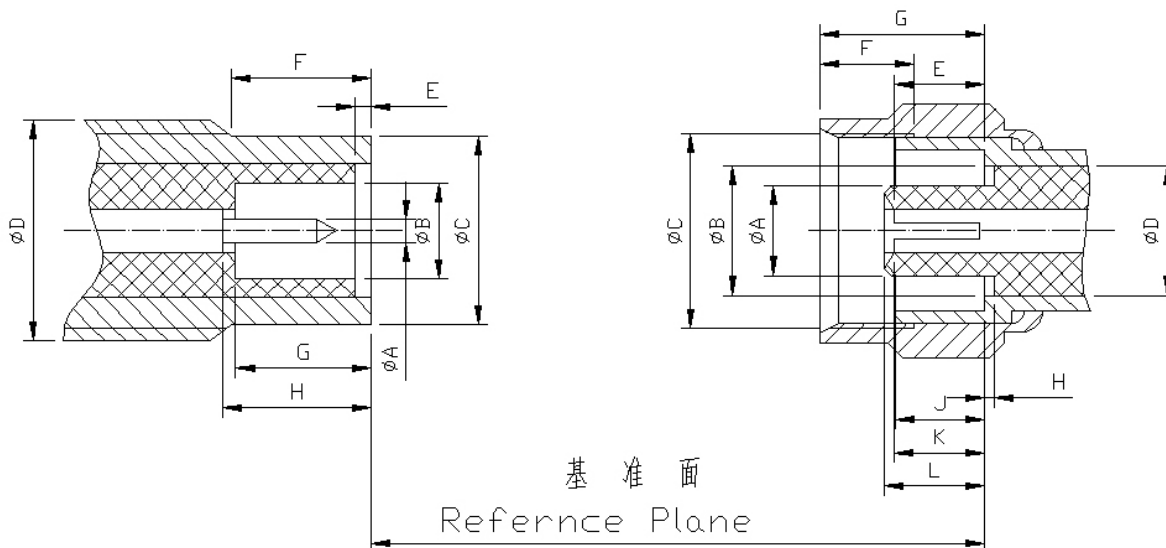

	PLUG (mm)	
	MIN	MAX
A	0.48	0.53
B	2.08	2.16
C	3.63	3.71
D	-	10-32 LINE 2A
E	-	0.3
F	3.12	3.38
G	3.4	3.66
H	3.4	3.76

	JACK (mm)	
	MIN	MAX
A	2	2.06
B	3.73	3.81
C	-	10-32 LINE 2B
D	-	3.05
E	2.79	-
F	2.79	-
G	-	5.92
H	-	0.3
J	-	3.1
K	3.05	-
L	3.15	3.4

SMC Series

电 缆 连 接 器 Connectors for Cable

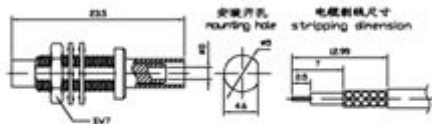

产品型号	电缆型号	备 注
SMC-JY3	SFF-50-1.5-1 RG316/U	

SMC-JY3

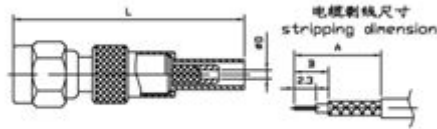

产品型号	电缆型号	L	D	A	B
SMC-K2	SFT-50-1 RG178/U	24.2	Ø0.9	9.1	3.6
SMC-K3	SFT-50-1.5-1 RG316/U	28.0	Ø1.6	8.3	3.3

SMC-K2

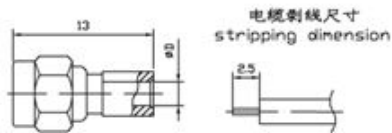

产品型号	电缆型号	D	备 注
SMC-KB2	SFT-50-2-1 RG405/U	Ø2.2	
SMC-KB3	SFT-50-3-1 RG402/U	Ø3.6	

SMC-KB2

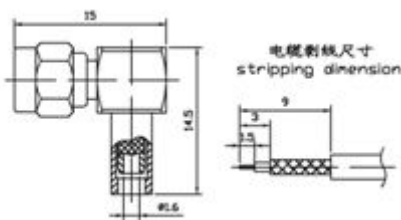

产品型号	电缆型号	备 注
SMC-KW3	SFF-50-1.5-1 RG316/U	

SMC-KW3

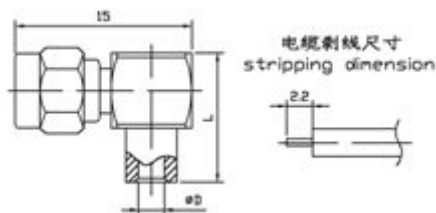

产品型号	电缆型号	L	D
SMC-KWB2	SFT-50-2-1 RG405/U	11.0	Ø2.2
SMC-KWB3	SFT-50-3-1 RG402/U	11.6	Ø3.6

SMC-KWB2

穿孔安装式终端连接器
Perforations Connectors with Solder End



SMC-JYD

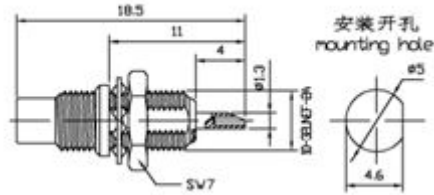

SMC-JYDA

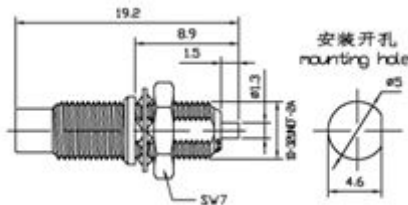

印制板安装连接器
Connectors for PC Board Mounting



SMC-JHD

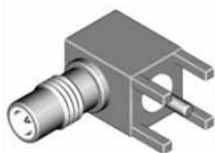
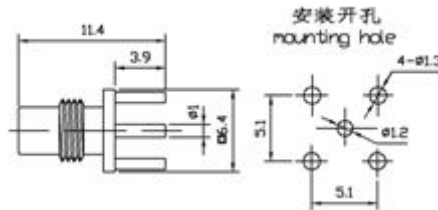

SMC-JWHD

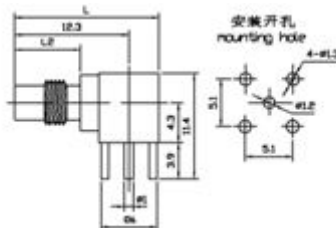

产品型号	L	L1	L2
SMC-JWHD	15.5	12.3	7.1
SMC-JWHD1	21.6	18.4	13.2